



15 Landhead Road  
Ballymoney  
Co. Antrim  
BT53 7HD

**Manor Architects**  
Stable Buildings  
Manor House  
30a High Street  
Money more  
L'Derry BT45 7PD

tel: (028) 8674 8367  
email: [ma@manorarchitects.com](mailto:ma@manorarchitects.com)  
web: [www.manorarchitects.com](http://www.manorarchitects.com)

Lynsey McCaw & Emma Hudson  
The Planning Department  
Causeway Coast & Glens Borough Council  
Cloonavin  
66 Portstewart Road  
Coleraine  
BT52 1EY

Our Ref: 1931/Corr/PL13  
Your Ref: LA01/2020/0975/F  
Date: 26<sup>th</sup> Sept 2022

Dear Lynsey

**Re: Additional Supporting Information for Planning Team & Planning Committee  
Planning application for 2no. proposed infill detached dwellings with associated garages and shared access, due south of 56 Lisnagrot Road, Kilrea, Coleraine.  
Planning Ref: LA01/2020/0975/F**

We write to request a deferral of the noted application scheduled for Wednesdays council meeting.

We are in receipt of the reasons for refusal and as such have provided additional information in the form of attached PDF which we believe would address concerns in relation to ancillary works in the creation of visibility splays.

This request is to allow planning service time to assess and for us to submit hard copies.

We would also seek a deferral to allow councillors the time to visit the site and consider whether the garage noted is and can be considered as part of the reading of the site and road frontage, which is the core issue.

We look forward to hearing from you and should you have any questions or queries please feel free to contact us at any time.

Yours sincerely

Dip (Arch). M (Arch). ARB. RSUA. RIAS. RIAI. SCA. AMAE.

**Director/ Architect/ Specialist Conservation Architect**

Manor Architects Ltd. Reg. No. 46108

Directors:

Aidan M. Bradley

Johann C Muldoon MBE BSc (Hons). Dip.Arch. M.Arch. RIBA. RSUA. RIAS. RIAI. SCA. AMAE.

'Best Woman Architect in Europe 2017' 'Most Influential Woman in Architecture UK 2018'



RSUA



RIAS



GENERAL LANDSCAPE NOTES:

New & Supplementary Hedge Planting:  
Suitable species include Hawthorn, Holly,  
Guelder rose, Elder, Rusty Willow & Hazel

New Tree Planting:  
Trees to be provided as heavy standards or  
planted with a stake that allows them to  
hedge gaps and marks the presence of the  
council white oak. Suitable species to  
include: Country Elm, Silver Birch, Small  
White, Common Alder & Parkinsonia Oak

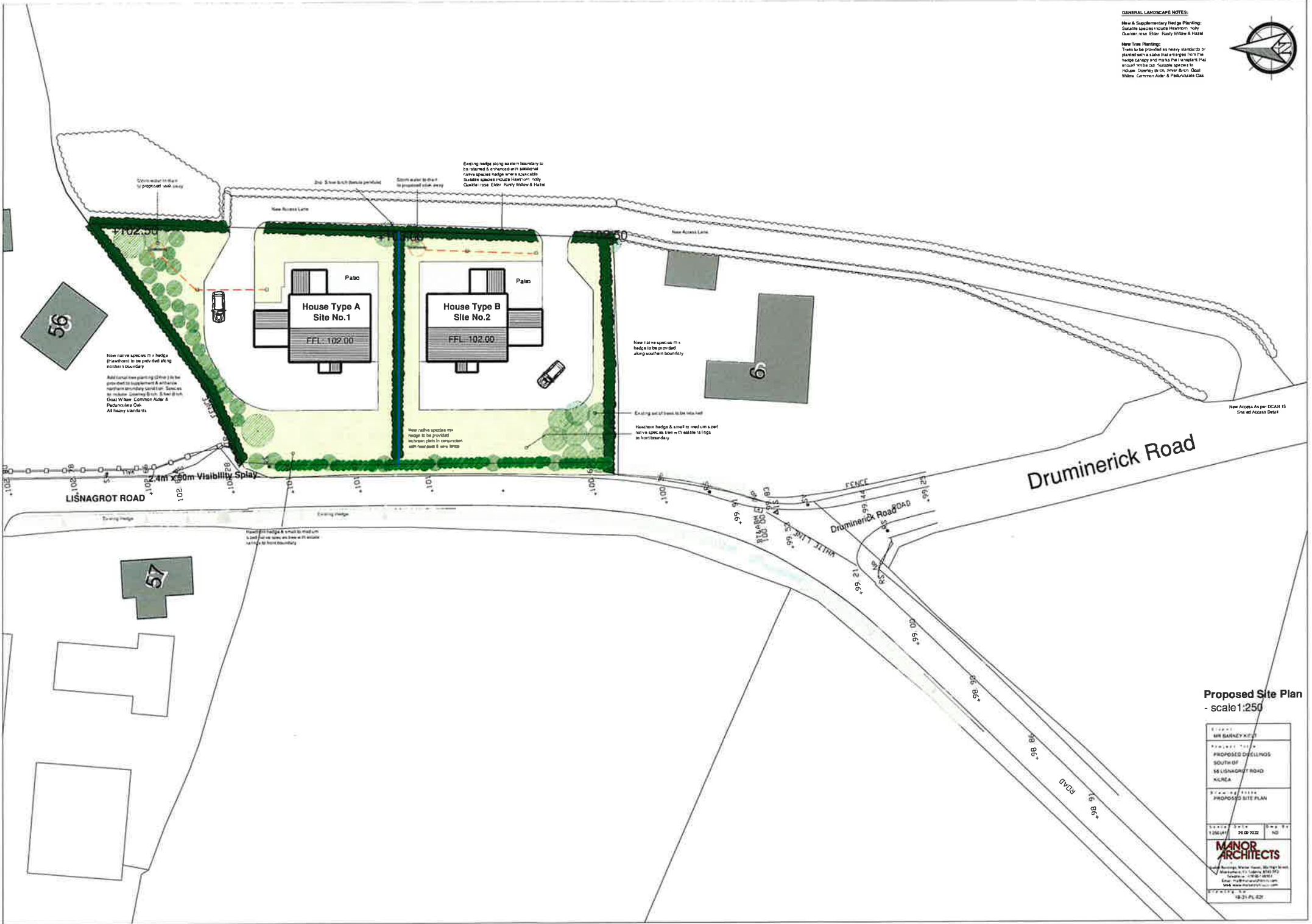

New Access As per DCAN 15  
Scale of Access Detail

# Drumnerick Road

## LISNAGROT ROAD

### Drumnerick Road ROAD

Proposed Site Plan  
- scale 1:250

MR GUNNEY KID	
PROPOSED DWELLINGS SOUTH OF 14 LISNAGROT ROAD KILREA	
PROPOSED SITE PLAN	
SCALE 1:250	DATE 24.09.2022
<b>MAJOR ARCHITECTS</b>	
1000 GARDENS, WATER FORT, BALLYVAUGHAN, DUBLIN 14	
Email: info@majorarchitects.com	
Web: www.majorarchitects.com	
18.31 PL 02	